

JEFFERSON BLVD

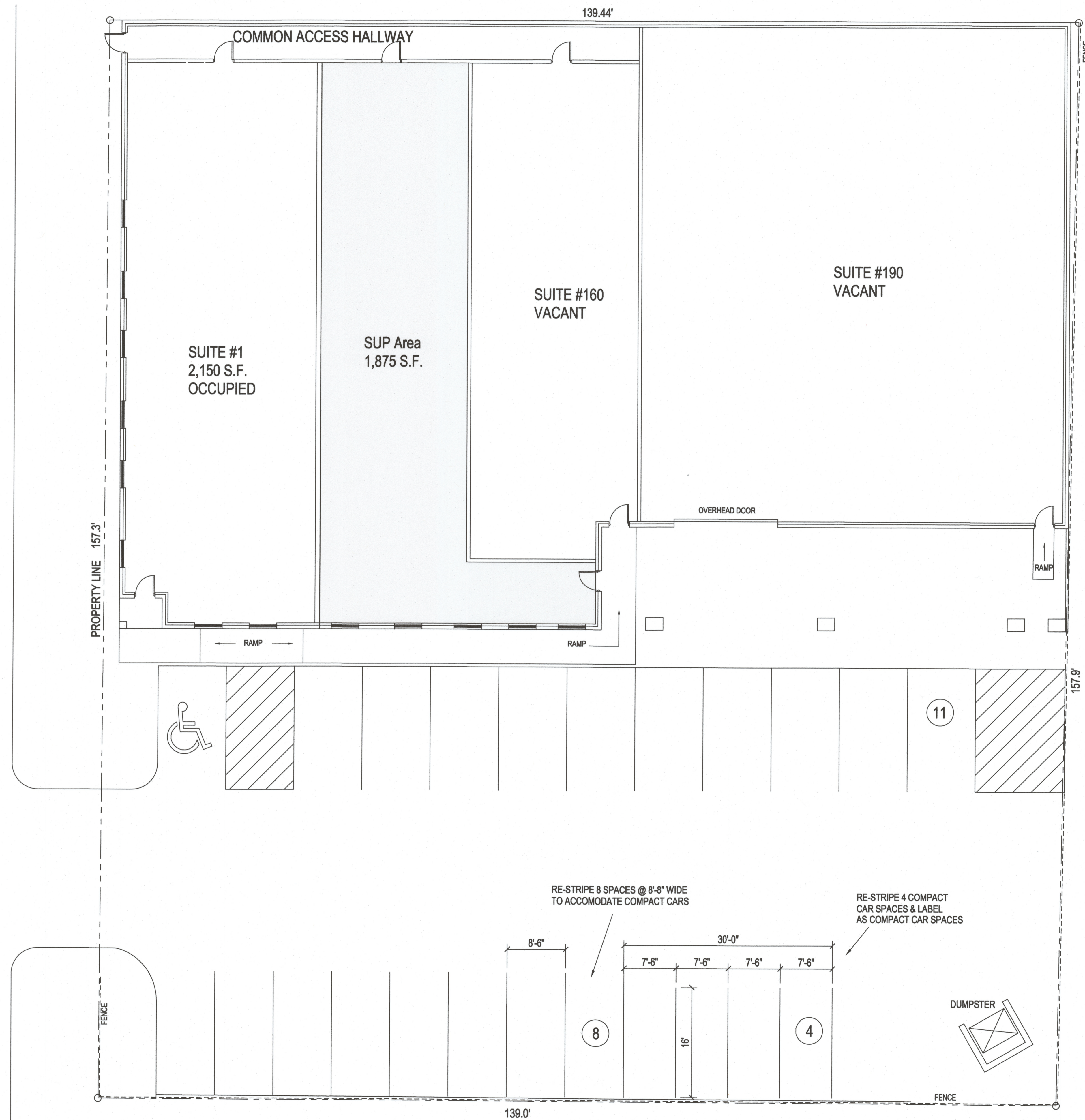

PARKING ANALYSIS				
SUITE #	TENANT	SQUARE FOOTAGE	USE	PARKING REQUIRED: RATIO 1:366
1	OCCUPIED	2,150	DENTAL OFFICE	5
130	SUP AREA	1,875	DENTAL OFFICE	11
			PARKING REQUIRED	16
			PARKING PROVIDED	23

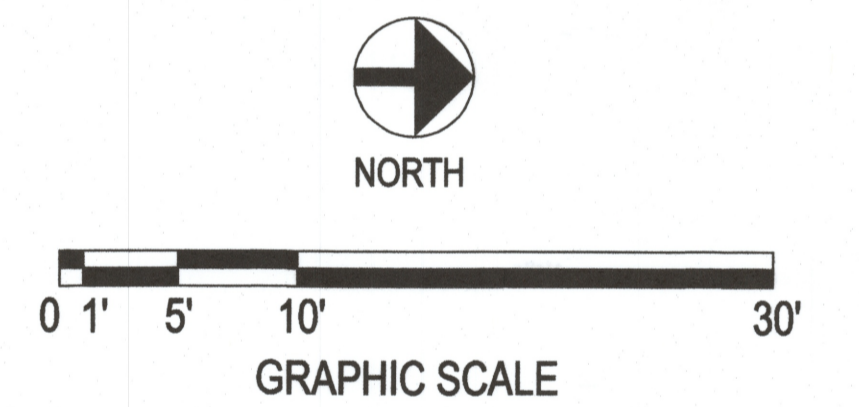

AREA RESERVED FOR STAMPS

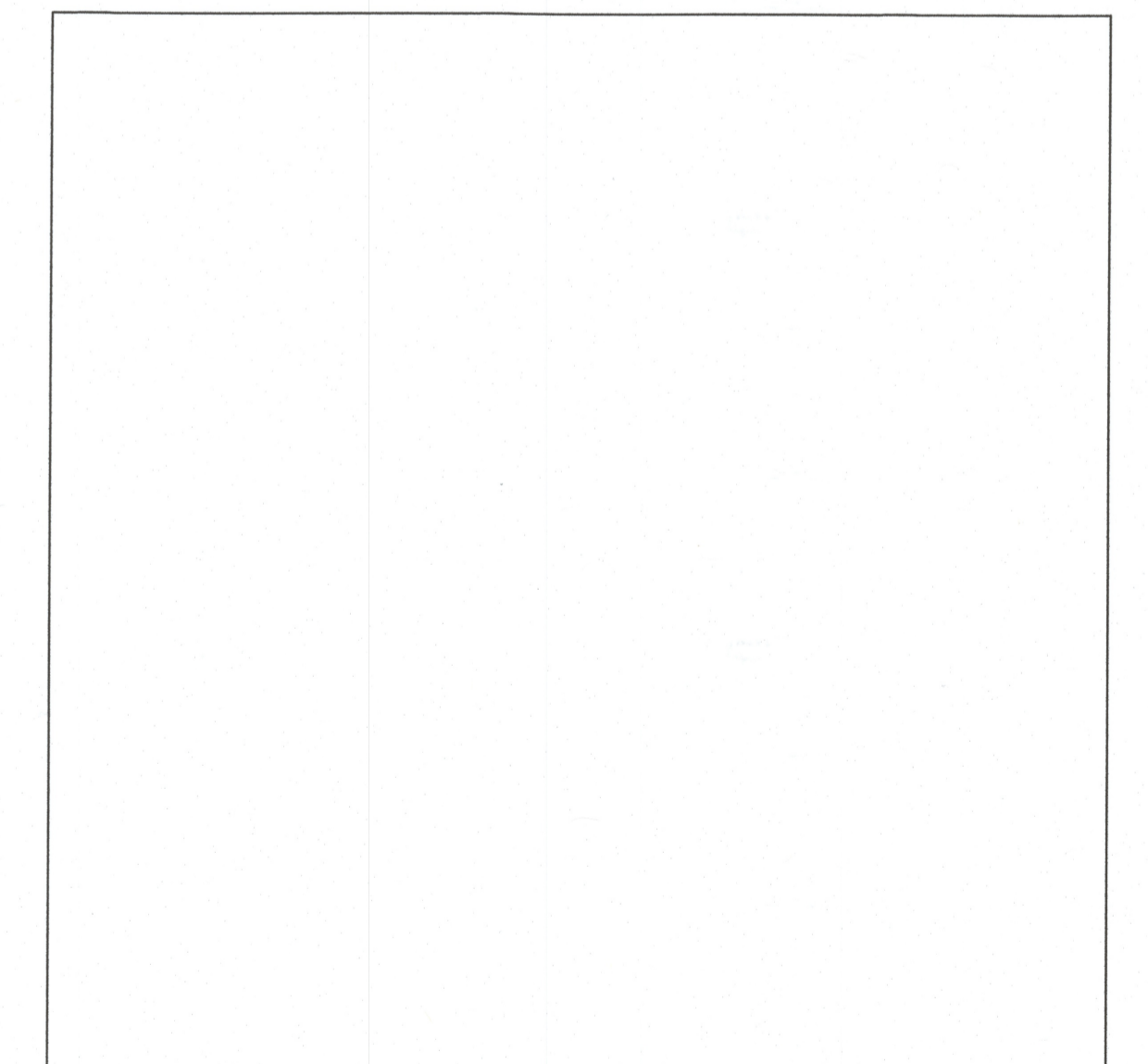

SITE PLAN			
JEFFERSON BUILDING 817 W. JEFFERSON BLVD. DALLAS, TEXAS 75208			
SCALE: 1/8" = 1'-0"	DATE: 4/24/17	REVISION:	5C
ZONING CASE #:	SHEET:		
Z167-256(OTH)	S-1		